

# Chapter 5 Hinges, Heavy Duty Hinges , and Table Hinges

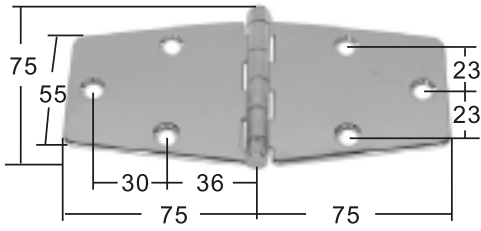

**HINGE stamped AISI 304 buff polished**

ITEM NO.	Thickness	Weight/g
<b>006074</b>	2 mm	176

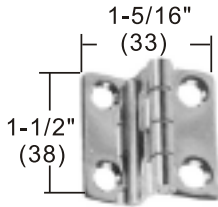

**SHORT SIDE OFFSET HINGE**

stamped AISI 304 buff polished

ITEM NO.	Thickness	Weight/g
<b>006045</b>	1.5 mm	26

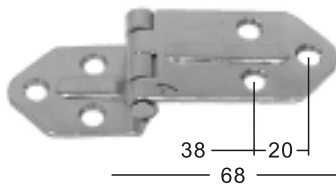

**STAMPED AISI 304 buff polished**

ITEM NO.	Thickness	Weight/g
<b>006068</b>	2.5 mm	98

*on request AISI 316*

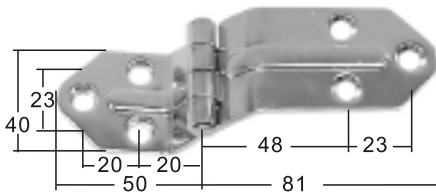
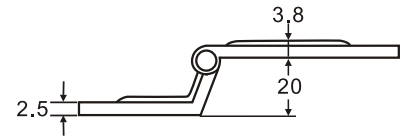

**STAMPED AISI 304 buff polished**

ITEM NO.	Thickness	Weight/g
<b>006069</b>	2.5 mm	119

*on request AISI 316*

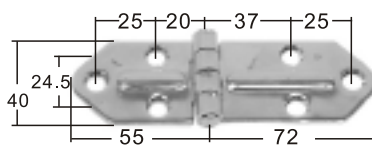
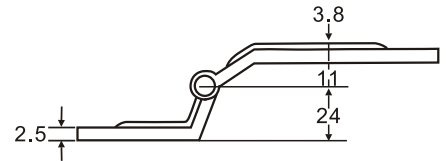

**HINGE stamped AISI 304 buff polished**

ITEM NO.	Thickness	Weight/g
<b>006076</b>	2.5 mm	102

*on request AISI 316*

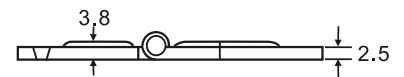

**SHORT SIDE OFFSET HINGE stamped AISI 304**

thickness:2mm

ITEM NO.	L mm	L1 mm	H mm	Weight/g
<b>006002</b>	49,5	18	10	62
<b>006003</b>	58	18	19	64

*on request AISI 316*

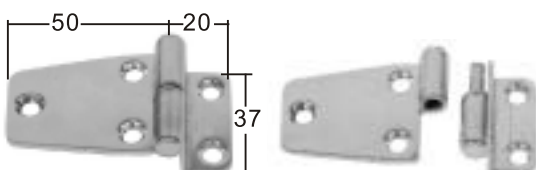
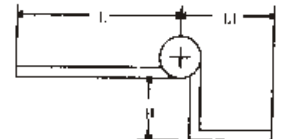

**TAKE APART HINGE stamped AISI 304**

Thickness:2mm

ITEM NO.	Weight/g
<b>007001</b> Right	54
<b>007002</b> Left (no picture)	54

*on request AISI 316*

